

## acoustic test data

All STS acoustic data is sourced, supplied and verified by independent, UKAS-accredited test facilities in accordance with all relevant British and European standards.

**Approved Document - 'E' (Passage of Sound)**  
**Approved Document - 'B' (Fire Safety)**  
**Approved Document - 'M' (Access To and Use of Buildings)**  
**Building Bulletin - 93 (Acoustic design in schools)\***

\* See also: "Acoustic Performance Standards for the Priority Schools Building Programme"  
including: "Technical Guidance Document TGD-021-5 Acoustic Performance in Schools"

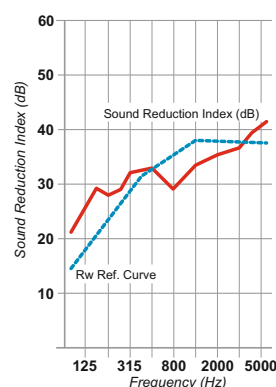

## STS 422GT Door-bottom seal

:18

### Characteristics / features

Product code	Size / Length	Colour(s)	Performance
STS 422GT - "SIZE"	VARIOUS	N / A	ACOUSTIC -
See table below	See table below		See STS data sheets :01 - :16

### Characteristics / features

Protects against / Resists	Fitting / installation	Material(s)
FIRE	See STS data sheet :19	Casing: ALUMINIUM (T60/60)
SMOKE		Seal: NEOPRENE/BUTYL
SOUND		Mechanism: STEEL/NYLON
DRAUGHT		
DUST		
INFESTATION		

### Sizes

Product size (pre-cut) mm	Product cuts back by (maximum) mm
330 430 530 730 930 1130 1330	120 120 140 200 200 200 200

### Adjustment

#### Uneven Threshold

Left to right

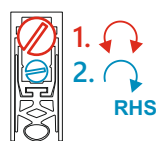
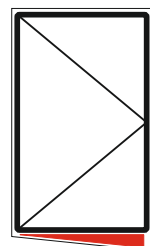

Adjust seal to close gap  
Turn for more downward pressure

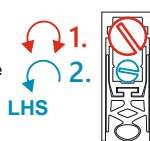

Right to left

